

22/08/2025

**To the St Marys Primary School, Parish Community, and Carpark Users,**

North Construction and Building Pty Ltd ("North") has been appointed by Catholic Schools Broken Bay as the managing contractor for upcoming construction works at St Marys Catholic Primary School.

The project involves alterations and additions to the existing school facilities, including upgrades to services, landscaping improvements, and carpark modifications. Works are scheduled to commence September 2025, with completion anticipated in early 2027.

*Initial Works and Schedule*

The initial phase will include site establishment, fencing, shed installation, demolition, and civil works. Construction activities will be carried out in accordance with the approved development consent (DA2036/2023), during the following hours:

- Monday to Friday: 7:00am – 5:00pm
- Saturday (as required): 7:00am – 5:00pm

*Site Access and Parking Adjustments*

Construction access will off Main Road via gates within the existing school fence adjoining the carpark. Whilst the carpark will remain operational, please note that three car spaces at the front of the site will be temporarily removed for construction access, and to meet Fire & Rescue NSW requirements. The proposed Stage 1 site management plan is attached for reference.

*Ensuring Safety and Minimising Disruption*

North has a strong focus on safety and is committed to minimising disruption and inconvenience to the school, parish, families, nearby residents, and local businesses. We will implement all reasonable measures to ensure safety and reduce noise, dust, and other impacts throughout the project.

*Communication and Updates*

We are working closely with St Marys Catholic Primary School and the parish to ensure clear and timely communication. Regular updates will be provided to keep you informed of progress and upcoming activities.

North look forward to working together to ensure a smooth and respectful construction process.

Regards

**North Construction & Building Pty Ltd**

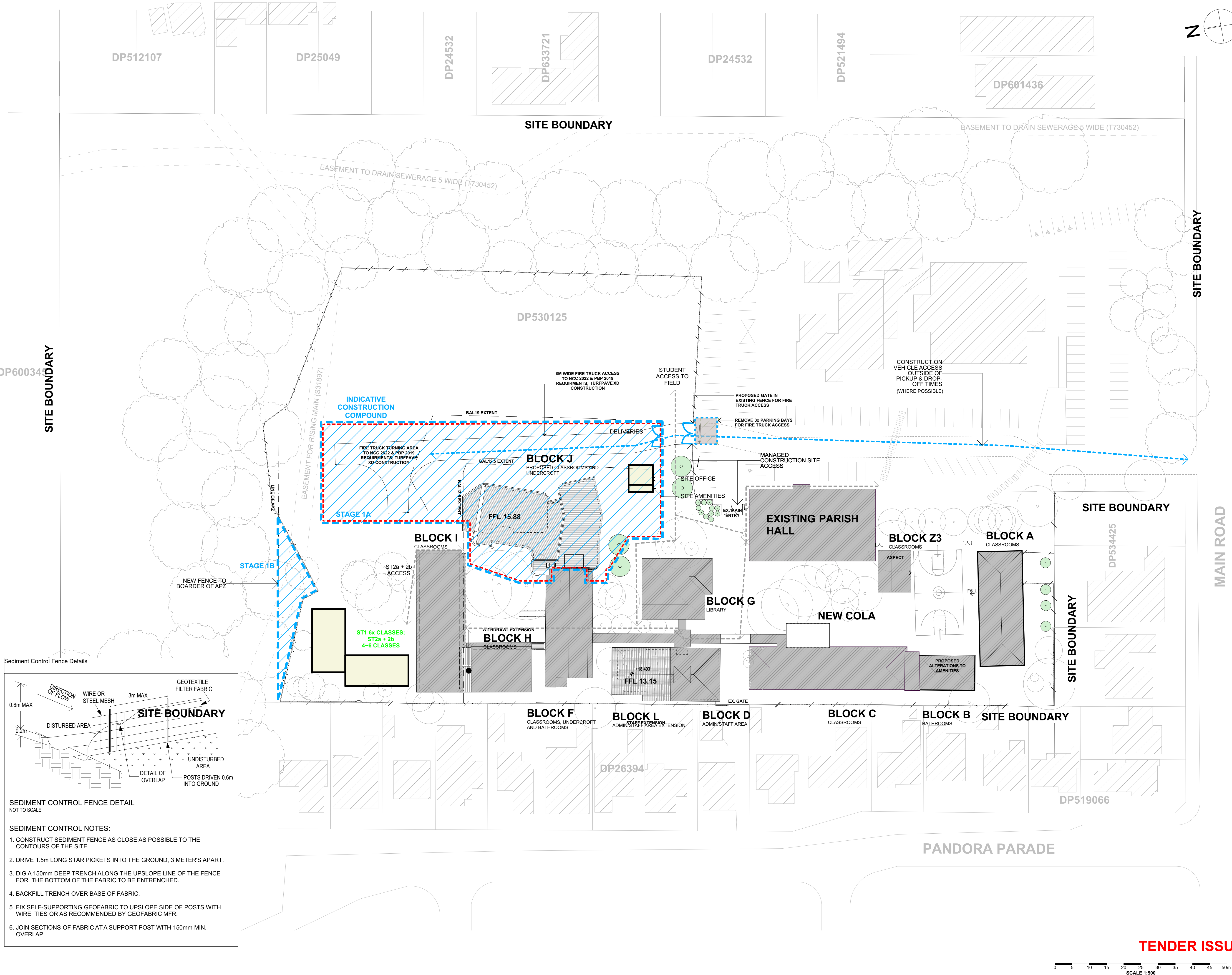

**NOTE**  
THE BUILDER SHALL CHECK ALL DIMENSIONS AND LEVELS ON SITE PRIOR TO CONSTRUCTION. NOTIFY ANY ERRORS, DISCREPANCIES OR OMISSIONS TO ARCHITECT. REFER TO WRITTEN DIMENSIONS ONLY. DO NOT SCALE DRAWINGS. DRAWINGS SHALL NOT BE USED FOR CONSTRUCTION PURPOSES UNTIL ISSUED FOR CONSTRUCTION. THIS DRAWING REFLECTS A DESIGN BY Glendenning Szoboszlai Architects and IS TO BE USED ONLY FOR WORK WHEN AUTHORIZED IN WRITING BY Glendenning Szoboszlai Architects.

ALL BOUNDARIES AND CONTAINS ARE SUBJECT TO SURVEY DRAWING ALL LEVELS TO AUSTRALIAN HEIGHT DATUM. IT IS THE CONTRACTORS RESPONSIBILITY TO CONFIRM ALL MEASUREMENTS ON SITE AND LOCATIONS OF ANY SERVICES PRIOR TO WORK ON SITE.

ALL DOCUMENTS HERE WITHIN ARE SUBJECT TO AUSTRALIAN COPYRIGHT LAWS.

**NOTE:** LABELS WITH AN "M" PREFIX DESCRIBES EXISTING ELEMENTS WITH NO WORK SCOPE AND IS PROVIDED FOR GENERAL INFORMATION ONLY.

**PROJECT PARTNERS**  
REFER TO CONSULTANT DOCUMENTATION WHEN DIRECTED  
- PCA CONSULTANT - BOA NICHOLSON - KRISHNA SUBRAMANIAN  
- CIVIL ENGINEER - BOA NICHOLSON - KRISHNA SUBRAMANIAN  
- HYDRAULIC ENG - BOA NICHOLSON - KRISHNA SUBRAMANIAN  
- LANDSCAPE ARCH - BOA NICHOLSON - KRISHNA SUBRAMANIAN  
- MECHANICAL ENG - BOA NICHOLSON - KRISHNA SUBRAMANIAN  
- DRY FIRE ENG - BOA NICHOLSON - KRISHNA SUBRAMANIAN  
- PLANNING CONSULTANT - BOA NICHOLSON - KRISHNA SUBRAMANIAN  
- VT CONSULTANT - BOA NICHOLSON - KRISHNA SUBRAMANIAN  
- STRUCTURAL ENG - BOA NICHOLSON - KRISHNA SUBRAMANIAN  
- SURVEYOR - BOA NICHOLSON - KRISHNA SUBRAMANIAN

**LEGENDS**

- ST1A (BLOCK J) INDICATIVE CONSTRUCTION COMPOUND
- ST1B INDICATIVE CONSTRUCTION COMPOUND
- ST2A (ALTS/ADDS) INDICATIVE CONSTRUCTION COMPOUND
- ST1B (COLADEMOUNTBLES) INDICATIVE CONSTRUCTION COMPOUND
- SEDIMENT CONTROL FENCE
- ST1A-B INDICATIVE VEHICULAR ACCESS
- ST2A INDICATIVE VEHICULAR ACCESS
- ST2B INDICATIVE VEHICULAR ACCESS
- INDICATIVE PRIMARY PEDESTRIAN ACCESS
- OCCASIONALLY MANAGED CONSTRUCTION VEHICULAR ACCESS FOR LARGE VEHICLES ONLY. CONSULT WITH SCHOOL ON ACCESS HOURS DURING SCHOOL TERM. NO ACCESS DURING STUDENT PICK-UP & DROP-OFF TIMES AND RECESS & LUNCH.

**NOTE:** DETAILED CONSTRUCTION MANAGEMENT PLAN DEFINING STAGING AND PRECISE CONSTRUCTION COMPOUNDS TO BE CONFIRMED BY HEAD CONTRACTOR AT DETAIL DESIGN/CONSTRUCTION CERTIFICATE STAGE.

**NOTE:**  
THE BUILDER TO REPAIR & MAKE GOOD ALL AREAS DISTURBED DURING CONSTRUCTION. ALL MAKING GOOD TO MATCH MATERIAL DISTURBED.

ISSUE	REVISION DETAILS	DATE
A	ISSUED FOR TENDER	21/03/2024

**GLENDENNING SZOBOSZLAY ARCHITECTS**

A: 2/605 Pacific Highway, Mt Colah, NSW, 2079  
T: (02) 9482 7033 F: (02) 9482 7201  
E: admin@gsarchitects.com.au

LOT 1  
PLAN TYPE DP 530125  
CLIENT

**CATHOLIC DIOCESE OF BROKEN BAY**

PH: (02) XXXX XXXX

DRAWING TITLE:  
**SITE MANAGEMENT STAGE 1A+B PLAN**

PROJECT NAME:  
**ST MARY'S CATHOLIC PRIMARY SCHOOL, TOUKLEY**

Drawn | Checked | SSJ MM  
Issue Date: 21/03/2024

DRAWING SCALE:  
**1:500 @ A1**  
@ A3

REVISION NO.  
**A**

PROJECT NUMBER:  
**1396**

DRAWING NO.  
**A-0500**

SCALE 1:500

0 5 10 15 20 25 30 35 40 45 50m

TENDER ISSUE